

4°TempShell Element and Frame

Ordernumber: A 1000 29uk / A 1000 30uk



4 °C
(+/-2) °C

Sealing
possible



LCD-thermometer
indicates actual
temperature

Ideal for medications and biologicals

Dimensions of one pair of
4°TempShell elements :

Outer: 270 x 155 x 65* mm

Inner: 210 x 110 x 30* mm

* Every add. frame increase size by 30 mm

Weight approx.: 800g

- designed to transport medication, erythrocytes, samples, etc
- liquid crystal thermometer indicates actual temperature
- create various inner volumes
- constant temperature for long terms (depending on insulation)
- protects your product against freezing, avoiding damage to the product (e.g. lysis).

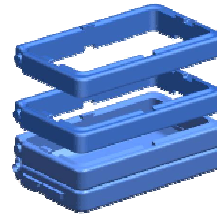

MODULAR PASSIVE SYSTEM

Create different volumes using delta T's 4°TempShell Frames to transport multiple blood bags, organs, biologicals, medication and pharmaceuticals.

APPLICATION

For the transportation and storage of samples, blood products, cell cultures, stem cells antibodies, proteins and temperature sensitive medications.

The 4°TempShell should always be used in conjunction with an insulated transporter i.e. the **MonoTripleBox**, **MiniVaqBox**, or the **SilverBag series**, 10l, 16l, 30l



GUARANTEED PROTECTION DURING STORAGE AND TRANSPORTATION

Whatever the climate, may it be tropical or arctic, be ensured that the 4°TempShell element will maintain a temperature between 2-8°C.

Thanks to the 4°TempShell, your products can be transported for hours or even days.

The 4°TempShell must simply be pre-cooled to the required temperature. Once pre-cooled, the fluid will have solidified which can easily be seen through the transparent casing.

Also available as 4°element
order no.:

200ml	A 1000 25 uk
1 L	A 1000 27 uk
3 L	A 1000 28 uk

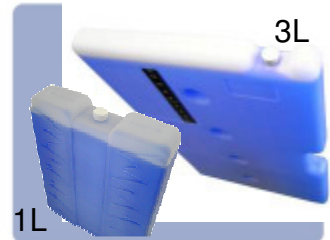

delta T GmbH
Kerkraider Str. 11
D-35394 Gießen

email: info@deltaT.de
For: ++49/6 41/4 80 92- 40
Fax: ++49/6 41/4 80 92- 42